

ITEM NO.	PART NUMBER	DESCRIPTION	MATERIAL	QTY.
1	FI .25 X 3 L 5.25	LENGTH: 5-1/4"	FI 1/4" x 3"	2
2	FI .25 X 3 L 6	LENGTH: 6"	FI 1/4" x 3"	2

REVISIONS			
REV.	DESCRIPTION	DATE	APPROVED
A	INITIAL RELEASE	3/20/2013	

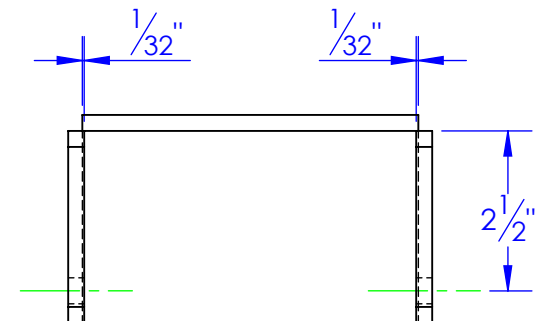
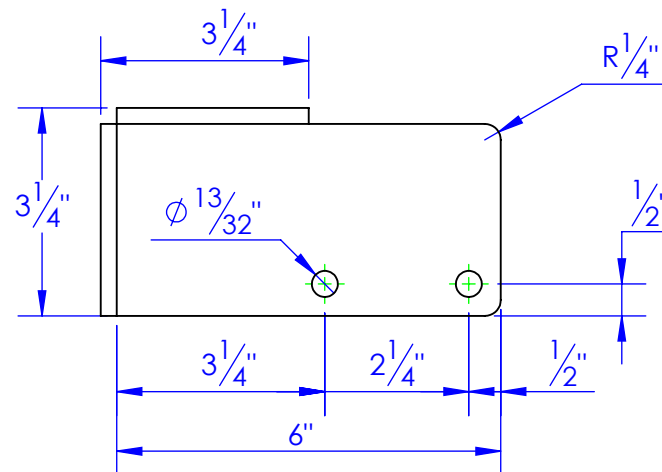
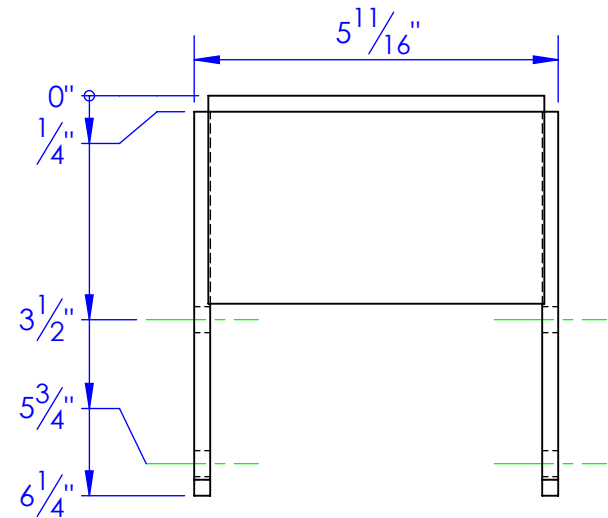
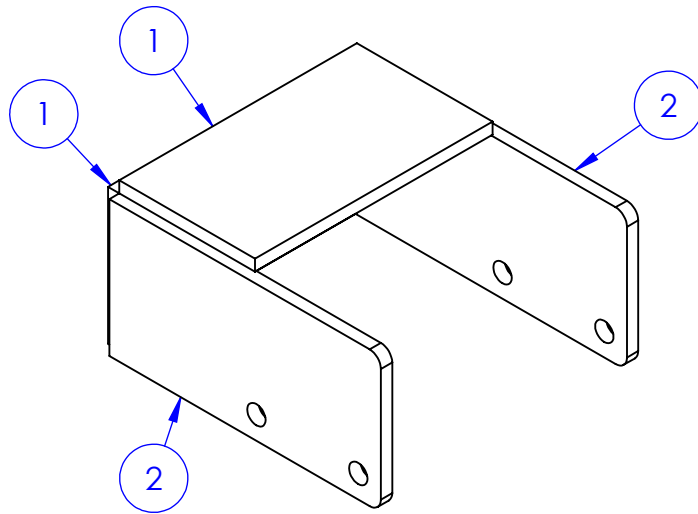

PROPRIETARY AND CONFIDENTIAL
THE INFORMATION CONTAINED IN THIS DRAWING IS THE SOLE PROPERTY OF TRIPLE C INC. ANY REPRODUCTION IN PART OR AS A WHOLE WITHOUT THE WRITTEN PERMISSION OF TRIPLE C INC. IS PROHIBITED.

DIMENSIONS ARE IN INCHES TOLERANCES: FRACTIONAL $\pm 1/16$ ANGULAR: MACH ± 1 BEND \pm TWO PLACE DECIMAL ± 010 THREE PLACE DECIMAL ± 005	
MATERIAL	--
DO NOT SCALE DRAWING	

NAME	DATE
DRAWN HEATH	3/20/2013
PART #	R&D FL BOOM
ASM #	TOP HOOK
COMMENTS:	
TOP HOOKS OF FORKLIFT BOOM LIFT FOR BEDS	

P.O. BOX 248,
SABETHA, KS 66534

TRIPLE C
INC.

SIZE A	DWG. NO. 95-1105	REV. A
SCALE: 1:3	WEIGHT: 4.75	SHEET 1 OF 1